

Lighthouse

POOLE'S CENTRE FOR THE ARTS

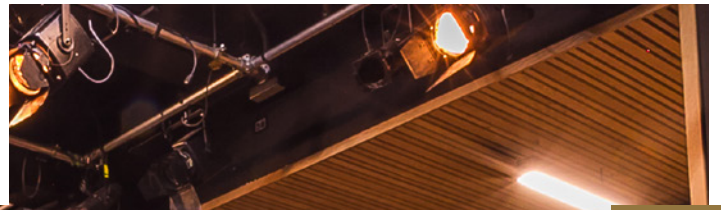

SHERLING STUDIO

A versatile space suitable for small scale performances, rehearsals, and talks.



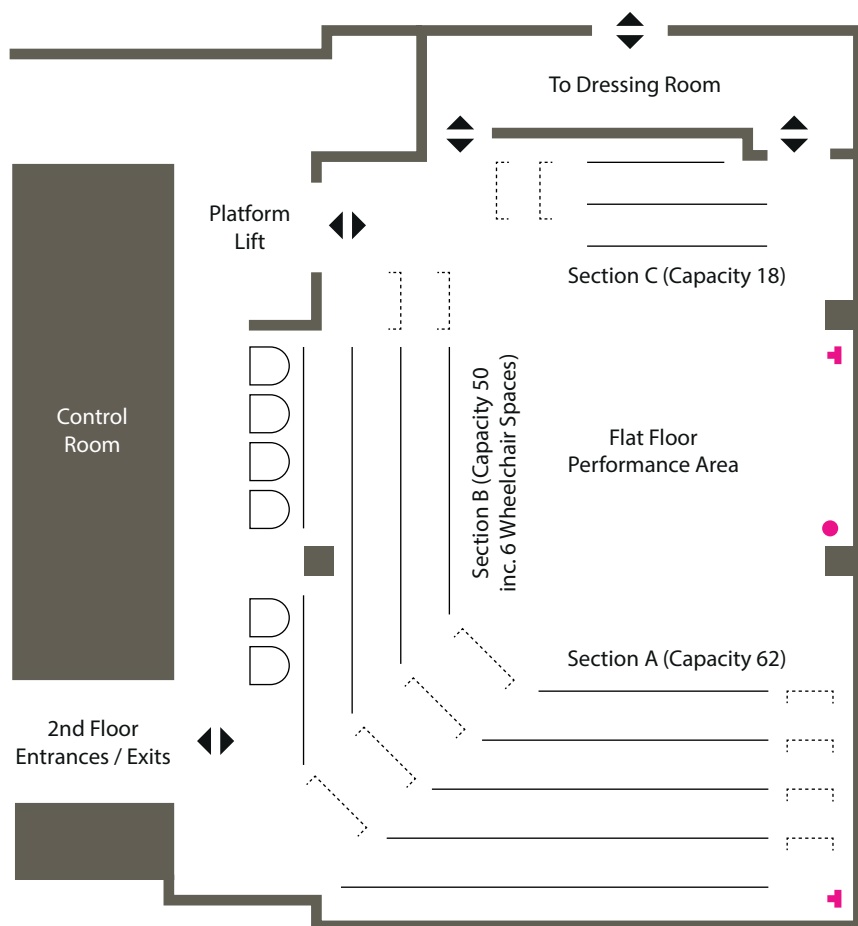

- 13 Amp Socket
- 16 Amp Power Supply (audio visual)

Full Technical specification available in request

AUDITORIUM SPECIFICATION

Seating Capacity	130 Unallocated bench seating
Stage	Flat floor
Stage Dimensions	6.85m width x 6.44m depth
Floor Finish	Polished wood floor
	Black linoleum floor cover can be provided
Height to Lighting grid	4.2m
Control Room	Fully equipped and soundproofed with sliding glass window

FRONT OF HOUSE ACCESS

Access	Level access from front of house
Wheelchair spaces	6 plus companion seating
Induction Loop	Infra Red hearing system
Wheelchair lift	Access to stage
Toilets	Male, female and disabled toilets close to the entrance to the Sherling Studio

TECHNICAL

Lighting	Full theatrical rig with ETC control
Sound	Built in PA system with DigiCo s21 sound desk
Power	16amp audio visual supply
	13 amp sockets around the venue
Projection	8,000 lumens projector
	3.6m x 2.1m screen
Piano	Yamaha C1 Baby Grand (Black) Tuned to A440
Load in access	Access from ramp within artists car par.
	Load in aperture 0.83m x 2.3m

BACKSTAGE FACILITIES

Dressing Room	1 x room for up to 8 that can be divided in to 2 if required
	En suite shower facilities
	Fully lit dressing table mirrors
	Hanging space
Green Room	With tea and coffee and microwave facilities
	Available to all artists working in the venue
	Free access back of house
Wifi	In dressing room and green room
Audio visual show relay	2 x washing machines and tumble driers available
Laundry	Shared across all venues and situated within Main house area
Ironing Board and Iron	Available in dressing room

CONTACTS

For details about hiring this venue please contact our Events Manager on **01202 781 300** or email **Emma.bovey@lighthousepoole.co.uk**

For further technical details please contact the Technical Manager on **Jake.Sutton@lighthousepoole.co.uk**

01202 781300

www.lighthousepoole.co.uk/hire



Supported using public funding by
ARTS COUNCIL ENGLAND



Charity Registration Number: 275961

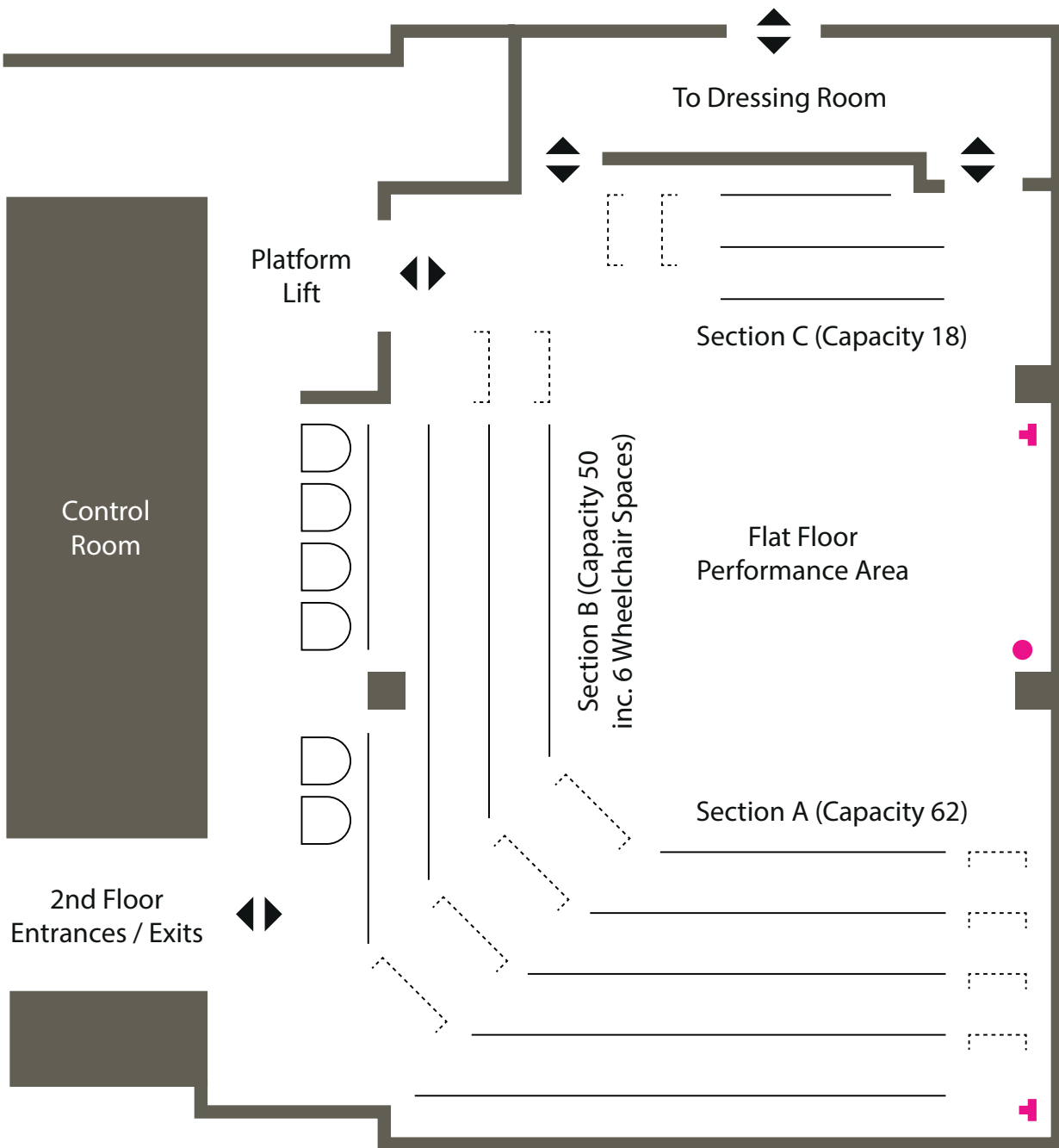

- 🔌 13 Amp Socket
- 16 Amp Power Supply (audio visual)