

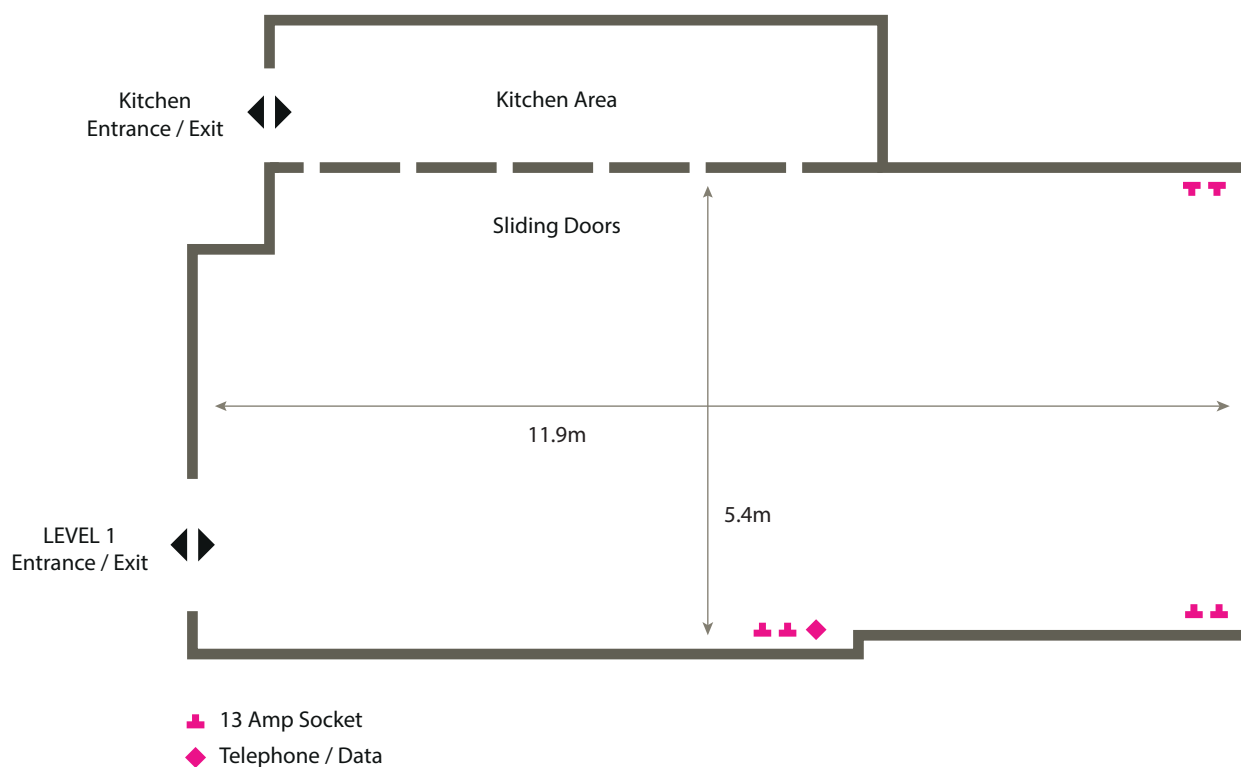

A versatile and functional space can be used for meetings, break space, rehearsals.



# FUNCTION ROOM THREE



## Full technical specification in request

### LEVEL

Level in building **1**

### TYPE OF ROOM /SPACE

Meetings  
Rehearsals  
Receptions

### DIMENSIONS (M)

Total square area [sq m] **64.26**  
 Max length **11.9m**  
 Maximum width **5.4m**

### CAPACITIES

Boardroom **20**  
 U-shaped **15**  
 Classroom **20**  
 Theatre style **40**  
 Drinks reception (no tables) **100**  
 Drinks reception (tables) **50**  
 Max **50**

### LIGHTING

Natural Light **Yes**  
 Blackout possible **Partial**  
 Dimmable lighting **Yes**

### POWER

13 amp sockets **4**

### TECH

50 inch LED display screen  
 In ceiling PA System  
 VGA, HDMI presenting capability  
 Infrared hearing loop system  
 2 microphones  
 Extra Equipment available  
 Dedicated conference wifi

### ACCESS

Direct street level load in **Ramped**  
 Direct lorry level load in **No**  
 Min load in aperture **1.5m x2.4m**  
 Wheelchair access **Yes**  
 Disabled toilets **Yes**  
 Lift to foyers **Yes x 2**  
 Toilet facilities (in room) **No**  
 Toilet facilities (in suite of rooms) **Yes**

01202 781300

[www.lighthousepoole.co.uk/hire](http://www.lighthousepoole.co.uk/hire)



Supported using public funding by  
**ARTS COUNCIL ENGLAND**



Charity Registration Number: 275961

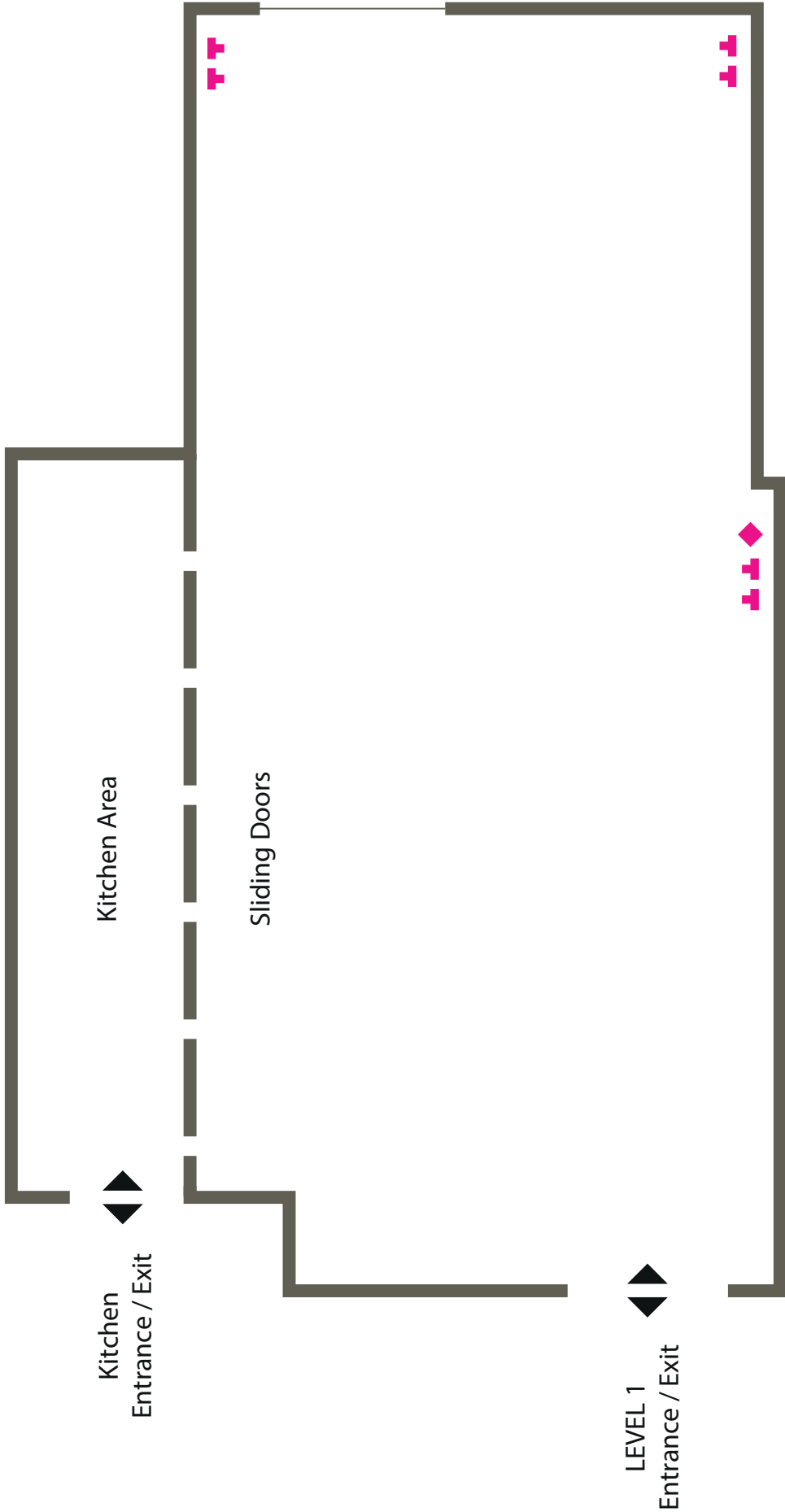

-  13 Amp Socket
-  Telephone / Data

# FUNCTION ROOM THREE